

- Dc-Dc Step-Down Converter
- Constant Current
- High Power LED Driver
- Wide Input Voltage Range
- High Efficiency (Up to 96%)
- Remote Control Function :
Analog Voltage Control
- Dimming Function :
PWM / Analog Voltage control (0~100%)
- 24 Pin Dip With Industry Standard Package And Pinout



ELECTRICAL SPECIFICATIONS :
At Nominal Input , Full Load and 25°C

Part Selection:

PART NUMBER	INPUT VOLTAGE (VDC)	OUTPUT CURRENT (mA)	OUTPUT VOLTAGE (V)	EFFICIENCY (%)
FA-LED-300	5-36V	300	2-32V	96
FA-LED-350	5-36V	350	2-32V	96
FA-LED-500	5-36V	500	2-32V	96
FA-LED-600	5-36V	600	2-32V	96
FA-LED-700	5-36V	700	2-32V	96
FA-LED-800	5-36V	800	2-32V	96
FA-LED-900	5-36V	900	2-32V	96
FA-LED-1000	5-36V	1000	2-32V	96
FA-LED-1100	5-36V	1100	2-32V	96
FA-LED-1200	5-36V	1200	2-32V	96

Note:

1. Vin = 24V, Iout = 300-1200mA

Specifications:

At nominal Input, rated output current and 25°C
DC Input Voltage: 5 - 36V (24V Recommended)
Output Voltage: 2 - 32V
Output Current: 300 - 1200mA (± 2% Accuracy)
Efficiency at Full Load: 96% Max (See Note 1)
Operating Frequency: 260KHz
Short Circuit Protection Regulated at the rated model current
Output Open Protection: No Load
Capacitive Load: 100uF max
Output Ripple and Noise: 120mVp-p max



HIGH POWER LED DRIVER

▪ Case Material: Non-Conductive Black Plastic 100°C max
▪ Potting Material Epoxy: (Flammability UL94V-0)
▪ Dimensions: 1.25x 0.8 x 0.4 inches (31.8 x 20.3 x 10.2mm)
▪ Operating Temperature Range: -40°C ~ +85°C (Free air convection)
▪ Storage Temperature Range: -40°C ~ +125°C
▪ Remote ON/OFF: DC ON Open or 0V < Vr < 0.6V (Leave open if not used) DC OFF 0.6V < Vr < 5V (1mA Max)
▪ Dimming Control: Max PWM Frequency (10%~90%) 200Hz (Leave open if not used) Analog Voltage (0%~100%) 0-4.5V (1mA max) FA-LED-300, 350, 500 0-6.5mA max) FA-LED-600, 700, 800, 900, 1000, 1100, 1200
▪ Relative Humidity: 95%

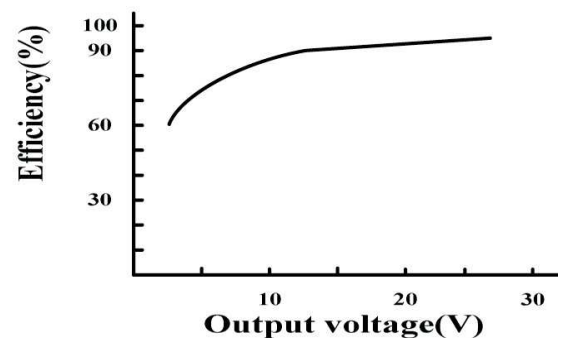

Mechanical Specifications

BOTTOM VIEW SIDE VIEW

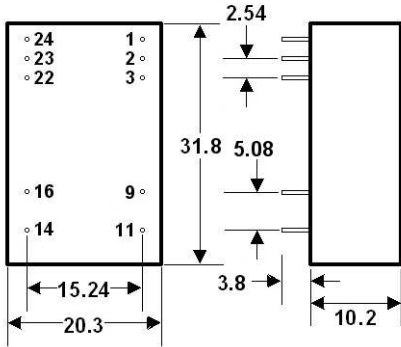

Tolerance	Millimetres
	.X ± 0.25
	.XX ± 0.25
Pin	±0.05

Recommended Pin Patterns Bottom View (2.54mm grids)

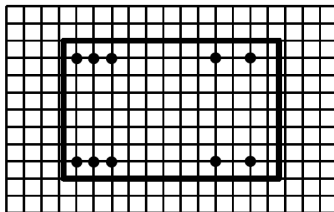

Pin	Single
2	Remote ON/OFF
22 & 23	+Vin
2 & 3	-Vin
9	NC
11	NC
14	LED+
16	LED-
24	DIM

Note:

- All specifications are typical at $T_a=25^\circ\text{C}$, nominal input voltage, resistive load and current unless otherwise noted.
- Specifications subject to change without notice.

Application Circuit

